

**2023 ONE-YEAR PLAN
FOR ASPHALT & CONCRETE & ARMOR COATING**

PROJECT NO.	ROAD NO.	IMPROVEMENT	LENGTH	ESTIMATED COST	FUNDING
C89(349)C	P26-P33 BET HWY 133-P35	ASPHALT	2.0 MILES	\$700,000	COUNTY FUNDING
C89(427)B	P16 BET HWY 75-27	CONCRETE SURFACING	2.0 MILES	\$3,000,000	COUNTY FUNDING
C89(443)B	TIMBER CREEK & NORTH RIDGE ROLLING ACRES	ASPHALT	1.5 MILES	\$650,000	LANDOWNERS & COUNTY FUNDING
C89(595)B	34 BET 47 & 51	ASPHALT	2.0 MILES	\$200,000	COUNTY/PRIVATE
C89(614)	19 BET 16 & 20	ASPHALT	2.1 MILES	\$200,000	COUNTY FUNDING
C89(633)	29 BET 22-24	ASPHALT	1.0 MILES	\$750,000	COUNTY FUNDING
C89(639)	4 BET HERMAN & 15	ASPHALT	5 MILES	\$1,500,000	COUNTY FUNDING & ENGINEERING
C89(640)	P32 BET 39-CALHOUN	CONCRETE RESURFACE	3 MILES	\$1,000,000	COUNTY FUNDING & ENGINEERING

SUB-TOTALS: \$8,000,000.00

BRIDGES & CULVERTS

PROJECT NO.	ROAD NO.	IMPROVEMENT	LENGTH	ESTIMATED COST	FUNDING
C89(533)	NEW YORK CREEK	BOX-CULVERT	0.1 MILES	\$100,000	(ARPA) COUNTY FUNDING
C89(565)	45 N/S OF ROAD 40	BOX-CULVERT	0.1 MILES	\$440,000	(ARPA) COUNTY FUNDING
C89(599)	38 BET 15 & 19	BOX CULVERT RECONSTRUCTION	0.2 MILES	\$100,000	(ARPA) COUNTY FUNDING
C89(635)	BURT CO LINE BET 3-5	TRIPLE BOX	0.1 MILES	\$275,000	(ARPA) COUNTY FUNDING
C89(636)	6 BET 5-7	TWIN BOX	0.1 MILES	\$225,000	(ARPA) COUNTY FUNDING
C89(638)	21 @ INTERSECTION P6	BOX-CULVERT	0.1 MILES	\$125,000	(ARPA) COUNTY FUNDING

SUB-TOTALS: \$1,265,000.

**ONE-YEAR PLAN FOR 2023
FOR GRADING & STAGE CONSTRUCTION PROJECTS**

PROJECT NO.	ROAD NO.	IMPROVEMENT	LENGTH	ESTIMATED COST	FUNDING
C89(349)A	P26 & P33 BET HWY 133-P35	ENGINEERING IN PROGRESS	2.0 MILES	\$50,000	COUNTY
C89(349)B	P26 & P33 BET HWY 133-P35	STAGE CONSTRUCTION	2.0 MILES	\$250,000	COUNTY
C89(427)A	P16 BET HWY75 & 27	STAGE CONSTRUCTION	2.0 MILES	\$75,000	COUNTY
C89(443)A	TIMBER CREEK NORTH RIDGE ROLLING ACRES	STAGE CONSTRUCTION	1.5 MILES	\$100,000	LANDOWNERS & COUNTY FUNDING
C89(477)	LOOKING GLASS	GRADING & TREE REMOVAL	1.0 MILES	\$25,000	COUNTY
C89(519)	51 BET P40 NORTH	GRADING & ROAD IMPROVEMENTS	1.0 MILES	\$50,000	COUNTY
C89(549)	25 BET P10 & P4	GRADING & ROAD IMPROVEMENTS	1.0 MILES	\$25,000	COUNTY
C89(595)A	34 BET 47-51	ROAD & SHOULDER REPAIR	2.0 MILES	\$150,000	COUNTY/PRIVATE

SUB-TOTALS: \$725,000.00

GRAND TOTALS

1. TOTALS FOR ASPHALT/CONCRETE

\$8,000,000.00

2. TOTALS FOR BRIDGES & BOX-CULVERTS

\$1,265,000.00

3. TOTALS FOR GRADING & STAGE CONSTRUCTION:

\$725,000.00

GRAND TOTALS FOR ALL CATEGORIES: \$9,990,000.00

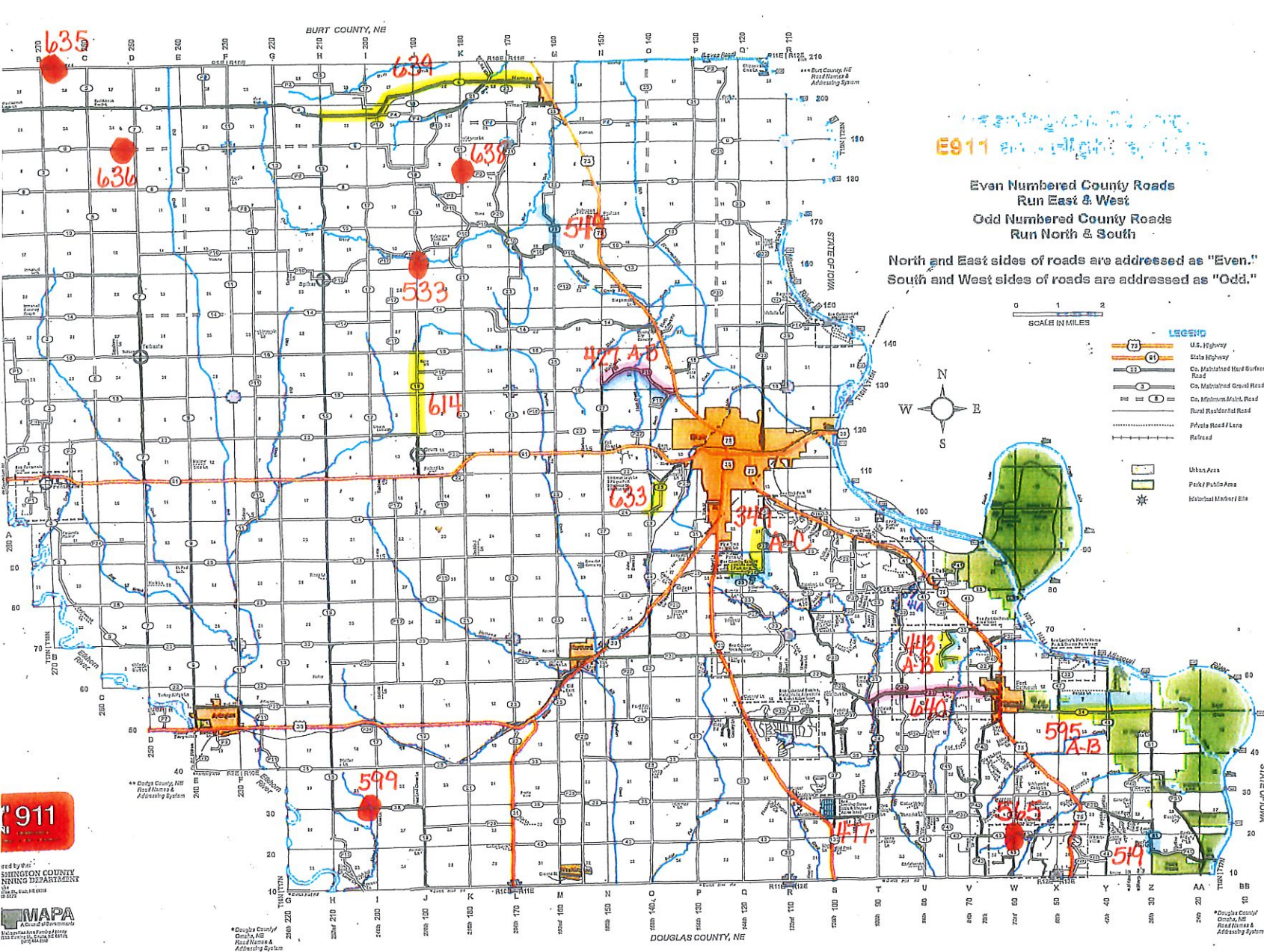

E911

2023 1yr Plan

Even Numbered County Roads
Run East & West
Odd Numbered County Roads
Run North & South

North and East sides of roads are addressed as "Even."
South and West sides of roads are addressed as "Odd."

0 1 2
SCALE IN MILES

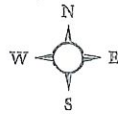

- LEGEND**
- U.S. Highway
 - State Highway
 - Co. Maintained Hard Surfaced Road
 - Co. Maintained Gravel Road
 - Co. Minimum Maint. Road
 - Rural Road/Local Road
 - Private Road/Lane
 - Refused
 - Urban Area
 - Park/Public Area
 - Historical Marker/Site

- Bridges
- Asphalt
- Concrete
- Grading

E911
SHERIDAN COUNTY
PLANNING DEPARTMENT
MAPA

Douglas County
Dodge, NE
Road Names &
Addressing System

DOUGLAS COUNTY, NE

Douglas County
Dodge, NE
Road Names &
Addressing System

**2023 SIX-YEAR PLAN
FOR ASPHALT & CONCRETE & ARMOR COATING**

PROJECT NO.	ROAD NO.	IMPROVEMENT	LENGTH	ESTIMATED COST	FUNDING
C89(444)B	40 BET HWY 75 & S/V	ASPHALT SURFACING	1.0 MILES	\$250,000	TWP #1 & COUNTY
C89(631)B	P33 P14-10	ASPHALT SURFACING	2.5 MILES	\$900,000	COUNTY

SUB-TOTALS: \$1,150,000.00

**SIX-YEAR PLAN FOR 2023-2029
FOR GRADING & STAGE CONSTRUCTION PROJECTS**

PROJECT NO.	ROAD NO.	IMPROVEMENT	LENGTH	ESTIMATED COST	FUNDING
C89(302)	26 BET 27 & 29	GRADING & WIDEN ROAD	1.0 MILES	\$150,000	COUNTY FUNDING
C89(345)B	34 BET CALHOUN & P34	STAGE CONSTRUCTION	1.5 MILES	\$500,000	COUNTY FUNDING
C89(346)	28 BET 3 & 9	STAGE CONSTRUCTION	2.5 MILES	\$150,000	COUNTY FUNDING
C89(360)	P40 BET HWY 75 & 49	STAGE CONSTRUCTION	1.5 MILES	\$60,000	COUNTY & TWP #1
C89(441)	5 BET 28 & 30	STAGE CONSTRUCTION	1.2 MILES	\$55,000	COUNTY FUNDING
C89(474)	26 BET 9 & 15	GRADING & ROAD IMPROVEMENTS	3.0 MILES	\$100,000	COUNTY FUNDING
C89(600)	29 BET P30 - DUTCH HALL ROAD	STAGE CONSTRUCTION	5.5 MILES	\$200,000	COUNTY FUNDING
C89(631)A	P33 BET P14-10	STAGE CONSTRUCTION	2.5 MILES	\$150,000	COUNTY FUNDING

SUB-TOTALS: \$1,365,000.00

GRAND TOTALS

1. TOTALS FOR ASPHALT/CONCRETE

\$1,150,000.00

2. TOTALS FOR BRIDGES & BOX-CULVERTS

\$0,000.00

3. TOTALS FOR GRADING & STAGE CONSTRUCTION:

\$1,365,000.00

GRAND TOTALS FOR ALL CATEGORIES: \$2,515,000.00

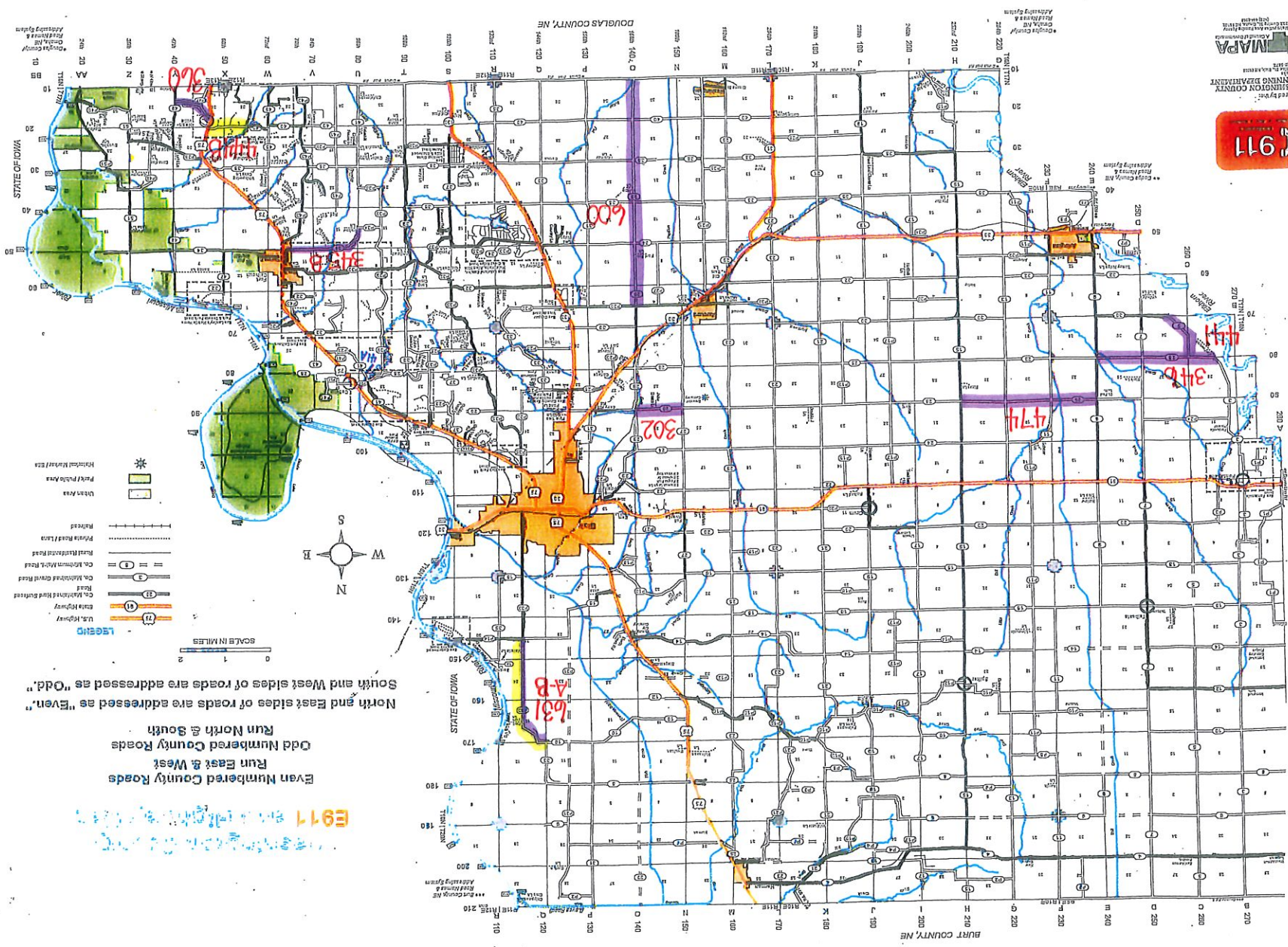

Even Numbered County Roads
 Run East & West
 Odd Numbered County Roads
 Run North & South
 North and East sides of roads are addressed as "Even,"
 South and West sides of roads are addressed as "Odd."

6 yr.
 Grading
 Asphalt

E911